

Drawer element
40780.0



TECHNICAL DATA

Order no.	40780.0 / 1 drawer	Mounting information	The walls installed on must meet the requirements of the furniture in terms of weight and the supplied fastening elements. If this cannot be guaranteed another method of installation needs to be chosen. For example with feet.
Dimensions (WxHxD)	597 x 413 x 455 mm		
Specification	Body/Front – hand lacquered melamine coated particle board with ABS edges, inside melamine white handle bar on the top of the drawer with 12 mm top	Colours Body/Front/ Glass cover plate	631 – White glossy 633 – Black glossy 634 – Grey matt 635 – Orange glossy
Weight	22,0 kg	Colours Handle	Black for black and orange furniture Chrome for all other furniture colours
Accessories excl.	Glass cover plate, order no. 40782.0 Feet (2 pieces), chromed, order no. 40762.0 Towel rail, chromed, order no. 49095.1, 49095.2		
Mounting acc. incl.	Installation set for furnitur, order no. 49401.2		

TECHNICAL DRAWINGS / S 1 : 20

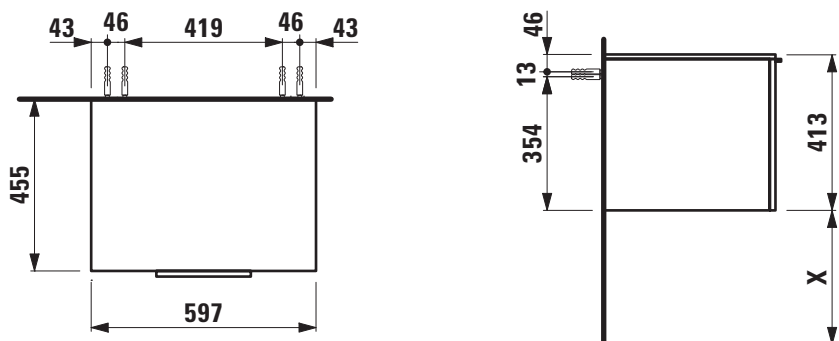

X = The exact hight must be set during installation.